

LOCATION

- Adjacent to the I-105 Century Freeway, one mile south of Los Angeles International Airport, in the beachside community of El Segundo. Easy access to all freeways

TRANSPORTATION

- 24-hour complimentary LAX Airport shuttle
- Scheduled local shuttle to El Segundo business centers
- Local tours and taxis available

ACCOMMODATIONS

- Five floors, 350 spacious two-room suites including:
 - King suites
 - Double/double suites
 - Family friendly suites
 - Executive suites
 - Executive boardroom suites
 - Wheelchair accessible suites
 - Non-smoking suites

SUITE FEATURES

- Suites surround a lush tropical atrium
- Private bedroom with one king size or two double beds
- Separate living room with sofa and well-lit dining/work table
- Galley kitchen with wet bar, microwave, coffeemaker and refrigerator
- Two dual-line speaker telephones with voice mail
- Two remote control color televisions with cable and in-suite movies
- Children 18 and under stay free in same suite with parents
- Wireless high-speed Internet access available

DINING AND ENTERTAINMENT

- 160-seat *Capistrano's Restaurant* features an eclectic menu specializing in seafood, pastas and California cuisine
- Our 80-seat contemporary lounge features a pool table and big screen TV with satellite sports
- Complimentary, full cooked-to-order breakfast served every morning
- Nightly Manager's Reception features your favorite beverages†

RECREATIONAL FACILITIES

- Indoor pool, whirlpool, sun deck and exercise room
- Tennis, golf, sailing, fishing and public parks within five miles

SERVICES

- Convenient indoor parking, gift shop, room service, laundry service, express checkout, on-site car rental desk, complimentary weekday USA TODAY®, and wheelchair accommodations.

LOCAL ATTRACTIONS

- Close to Los Angeles Air Force Base, at the center of Southern California's defense and aerospace community
- Two miles from Manhattan Beach
- Five miles from Hollywood Park Race Track and Marina del Rey
- Ten miles from Santa Monica
- 13 miles from Hollywood
- 15 miles from Downtown L.A., L.A. Coliseum and Staples Center
- 18 miles from Dodger Stadium
- 28 miles from Universal Studios®



EMBASSY SUITES
HOTEL®

Los Angeles — International Airport South



1440 E. Imperial Avenue, El Segundo CA 90245-2606

Telephone: 310-640-3600 Fax: 310-322-0954

email: LAXES_DS@hilton.com

www.laxsouth.embassysuites.com

For Reservations call the hotel directly or
Nationwide call 1-800-EMBASSY or visit our web
site at www.laxsouth.embassysuites.com
In Mexico call: [52] (5) 255 9061

Chain Code ES: SABRE 26987 / APOLLO 68493

WORLDSPAN 4440 / SYS ONE-AMADEUS LAXG26



DIRECTIONS

From the I-405 Freeway, take I-105 west to California Street and turn left.



†Subject to State and Local Laws. Must be of legal drinking age. Hilton HHonors membership, earning of Points and Miles®, and redemption of points are subject to HHonors Terms and Conditions. ©2006 Hilton Hospitality, Inc. SAG 06-0050/5M

MEETING SPACE FLOOR PLAN

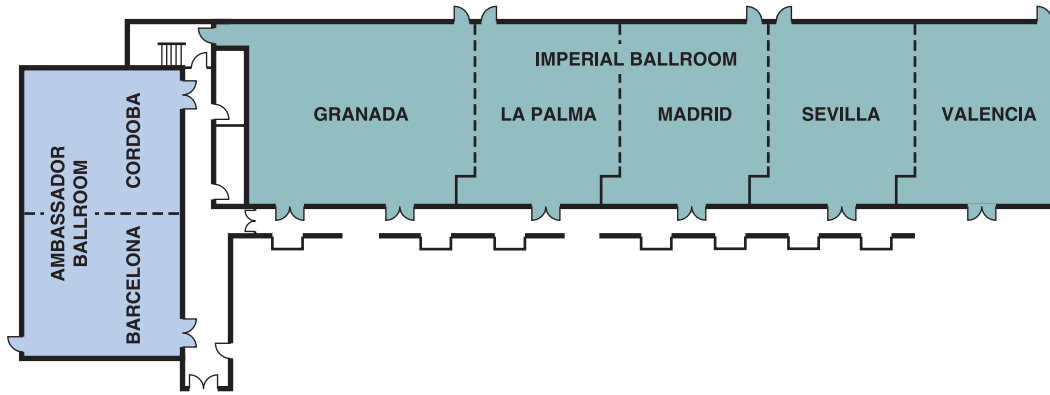

MEETING SPACE FLOOR PLAN

Meeting Room	Square		Ceiling Height	Cocktail			Class		Hollow Square	
	Feet	Dimensions		Seating	Banquet	Theater	Room	U-Shape Conference		
Ambassador Room	1,590	53' x 30'	9'	225	90	130	65	50	50	60
Barcelona	810	27' x 30'	9'	100	40	65	20	20	20	20
Cordoba	780	26' x 30'	9'	100	40	65	20	20	20	20
Imperial Ballroom	4,998	147' x 34'	9'	500	300	500	160	-	-	-
Valencia	918	27' x 34'	9'	100	50	75	25	25	25	25
Sevilla	918	27' x 34'	9'	100	50	80	30	30	30	30
Madrid	918	27' x 34'	9'	100	50	80	30	30	30	30
La Palma	918	27' x 34'	9'	100	50	80	30	30	30	30
Granada	1,326	39' x 34'	9'	110	60	100	40	40	40	40
Executive Boardroom Suites (5)	336	14' x 24'	8'	-	-	-	-	-	12	-
Executive Suites (7)	171	12.5' x 14'	8'	-	-	-	-	-	6-8	-
West Courtyard	-	-	-	250	200	275	-	-	-	-
East Courtyard	-	-	-	200	150	175	-	-	-	-
Dateline Patio	-	-	-	65	40	-	-	-	-	-

MEETING SPACE INFORMATION

- Over 10,000 square feet of meeting/banquet space
- Extensive catering menu with multitude of specialties
- Convention Services Manager at your service
- Audio/visual equipment available

MEETING GUARANTEE

- Designed to meet your requirements for a quality, productive meeting
- If any items specified in your signed contract are not fulfilled properly, you will be promptly compensated or credited

SUITE CAPABILITIES

- In addition to the above custom meeting space, every guest suite, with its built-in features and well-lighted work space, provides an excellent small meeting room

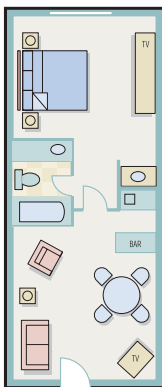

King Suite

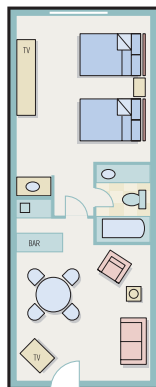

Double-Double Suite

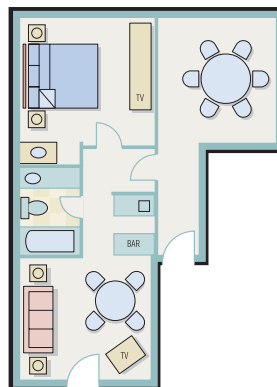

Executive Suite

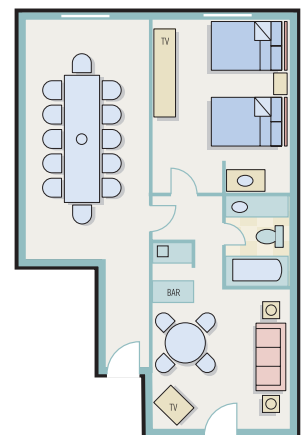

Executive Boardroom Suite

